

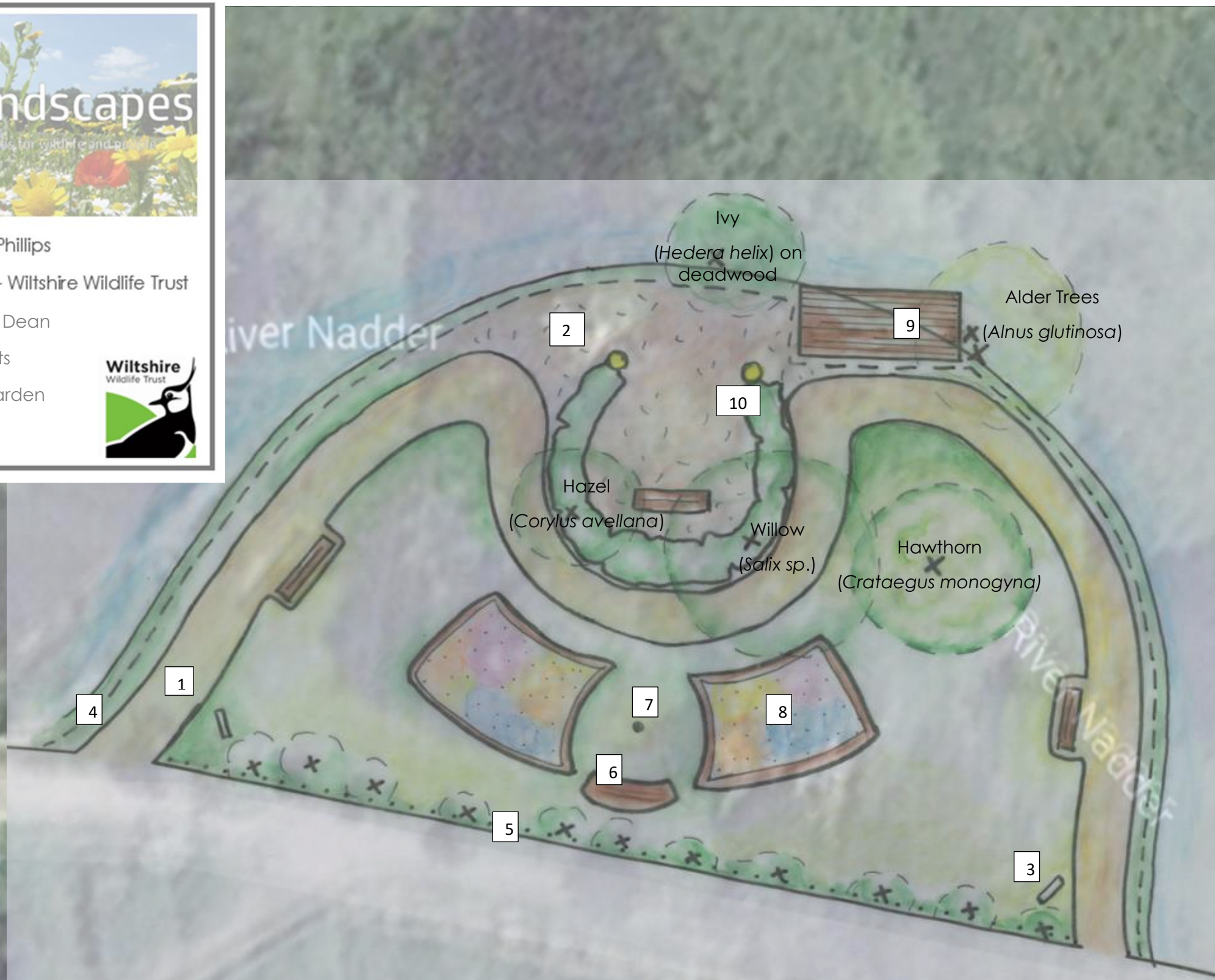

**Wild Landscapes**  
Creating green spaces for wildlife and people

Designer: Chelsie Phillips  
Wild Landscapes – Wiltshire Wildlife Trust  
Client: Ann-Marie Dean  
Location: Tisbury, Wilts  
Project: Sensory Garden  
Date: 11.04.19

- |  |   |
|--|---|
| <ul style="list-style-type: none"> <li>1- Hoggin pathway in natural compacted stone</li> <li>2- Natural bark chippings</li> <li>3- Interpretation/welcome boards at entrance and exit</li> <li>4- Wooden post and rail fencing along water bank</li> <li>5- Low hazel hurdle fencing along front footpath edge behind existing shrubs</li> </ul> | <ul style="list-style-type: none"> <li>6- Wooden benches, existing plus one new</li> <li>7- Central art feature/sculpture</li> <li>8- Planted sensory beds with wood edging</li> <li>9- 3.5X2m~ dipping platform at rivers edge with access gate</li> <li>10- Coloured markers near woodland seating</li> </ul> |
|--|---|